

RM-RS SERIES
ROLLER GRIZZLY FEEDER



Introduction.

Böhringer have been manufacturing Premier Material handling/process equipment for two thirds of a century, pioneering the advancement of how mineral's and reusable materials are processed today.



Put Böhringer at the heart of your operation.



About Böhlinger

Böhlinger. GMBH, was first Founded In Oedheim West Germany in 1948 by the Late Paul Böhlinger. From there Böhlinger. Gmbh became a respected World leader through its innovative product offering in the international Mining Recycling and aggregate processing World. Today Böhlinger equipment can be found in operation In every corner of the Globe.

Böhlinger first entered the North American market in July of 1984 through its subsidiary, "Böhlinger Inc." owned by its President Mr. Thomas M. Hecker. In 1996 Böhlinger Gmbh ceased operation due to a shrinking European Market for High end Systems. At this time Böhlinger Inc. acquired Sole rights to the Böhlinger Brands initially successfully supply a thriving US market with Foresight Böhlinger Inc. introduced the company's vast experience, know-how and technology in processing equipment systems to the American Aggregate & Recycled product producer and later to a growing International market.

Based on Böhlinger Inc. equipment criteria, and flexibility to adapt aggregate processing Systems' to customer's individual needs, and a steady, stable growth pattern, Böhlinger have been able to supply systems' at market price with advanced operating benefits. So far, Böhlinger Inc. conservatively have placed well in excess' of 350 specialized & standard systems' in various industries, with repeated sales to individual and group customers. Böhlinger Inc. has over 43 years of US and World product application knowledge.

A number of strategically situated Global Distributors' with Professional and experienced sales personnel in aggregate processing equipment have been engaged over the years for the stocking & marketing of our systems and spare parts. As of late all our equipment is being manufactured & assembled in North America, Europe and Asia. Major changes are taking place within Böhlinger creating a evolving focus on improving quarry/contractor operations, with an emphasis on applications, process, correct equipment selection and quality related issues arising in everyday aggregate production.

Sincerely Böhlinger Inc.

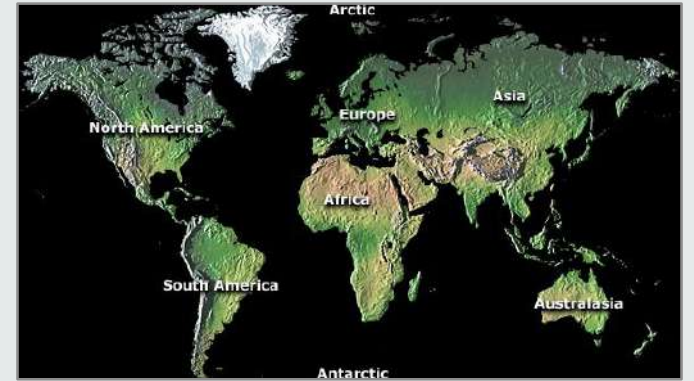

Paul Bohringer & Thomas Hecker in 1991.



SINGLE STAGE ROLLER GRIZZLY FEEDER.

USED IN,

- **STATIONARY APPLICATION OR MOBILE APPLICATIONS !**
- **AS SINGLE STAGE- OR IN COMBINATION WITH OTHER FEED SYSTEMS**

ELECTRIC DRIVE:-

OR HYDRAULIC DRIVE: OPTIONS AVAILABLE.



BÖHRINGER
HAVE BEEN SUCCESSFULLY DESIGNING AND
BUILDING ROLLER GRIZZLY FEDERS FOR OVER A
HALF CENTURY.
BOHRINGER PRODUCTS CAN BE FOUND IN SOME OF
THE TOUGHEST APPLICATIONS.

IN:-

USA.
RUSSIA.
CANADA
FRANCE
SOUTH AFRICA
SOUTH AMERICA



Principal

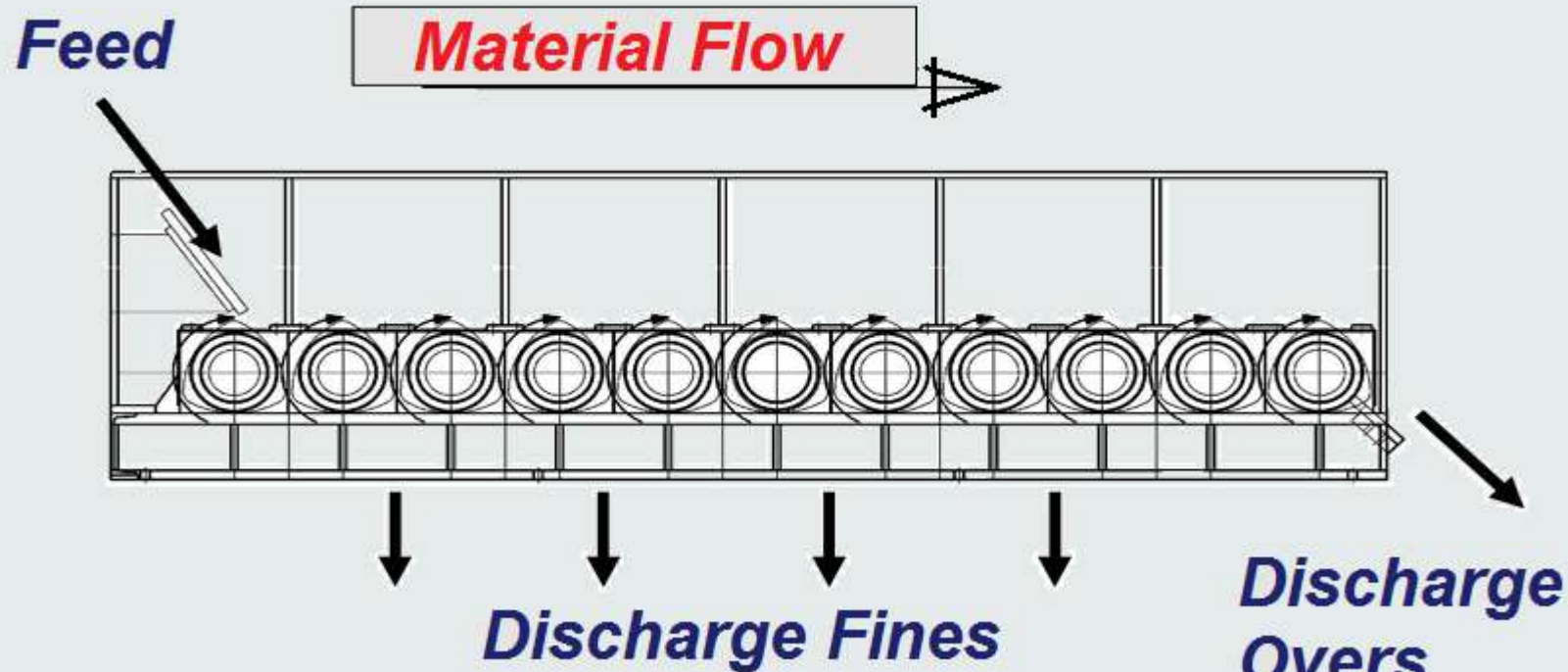

Difficult –sticky feed material/mineral deposits can be successfully processed using single or double stage/step roller grizzly feeders.

*No:
Blinding
Blockages
100% Self cleaning resulting in Clean feed, fines free for onward processing though Jaw, Impact Systems with increased overall production by as much as 50% and reduced wear.*

RM-RS



TWO STAGE ROLLER GRIZZLY FEEDER'S.

"COMPANY COFIDENTIALITY" - ALL RIGHTS ARE RESERVED



RM-RS

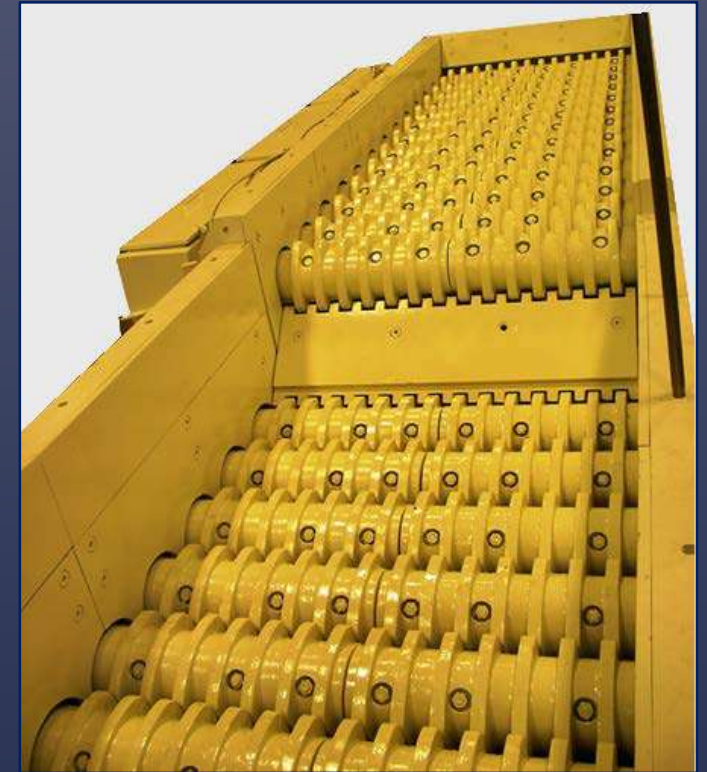

*"Solid" Shaft's quick
change Cam's unique to Böhlinger...*

*When Rip Rap
machines fail, "
the Böhlinger RGF
roll's on by...!"*





RGF feeders may be used in line with vibration grizzly feeders and screens for alternative cost effective solutions in some cases.

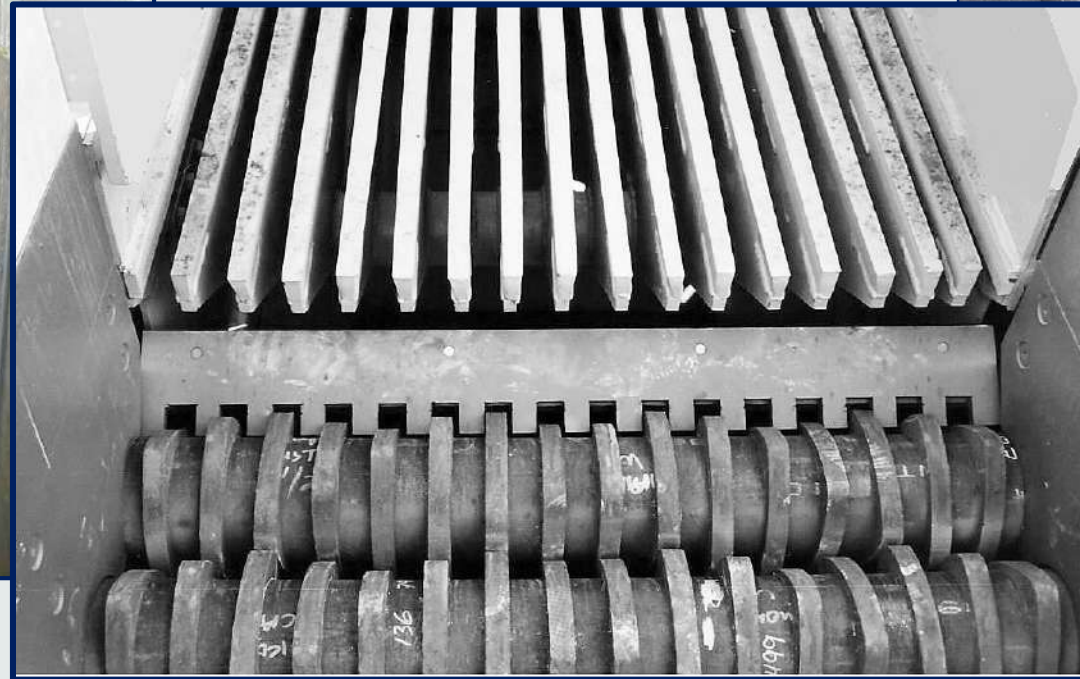

Two stage tumblers (roll's material) for enhanced separation-throughput

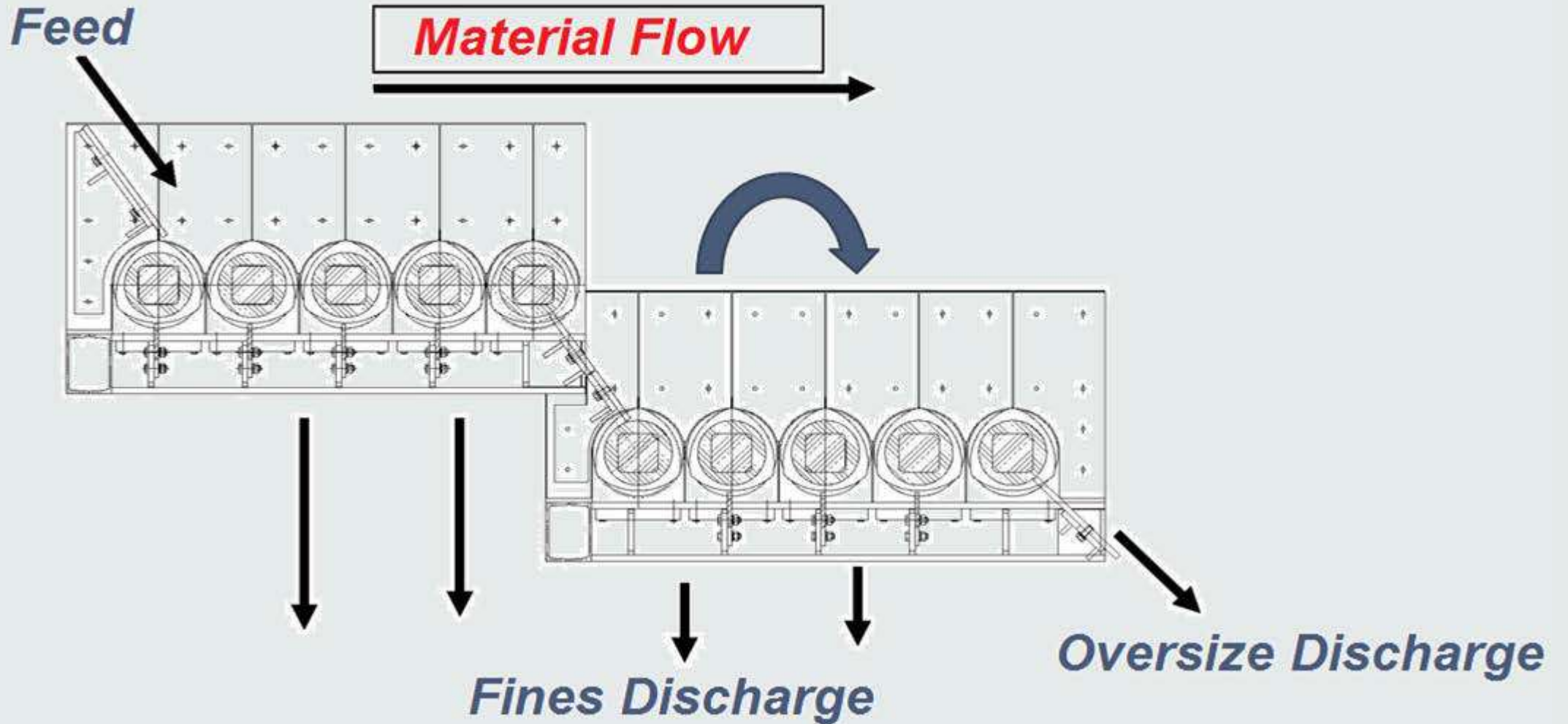

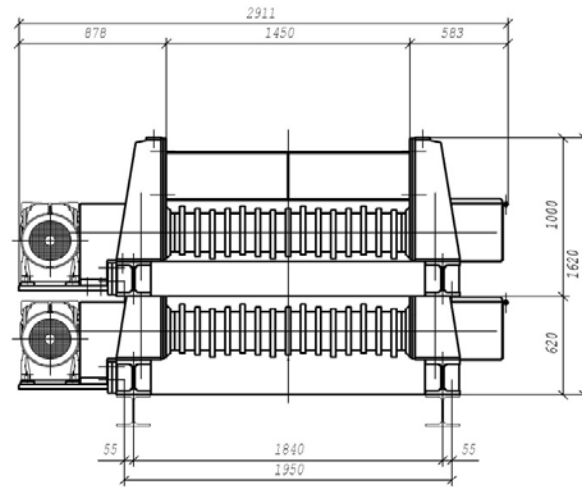
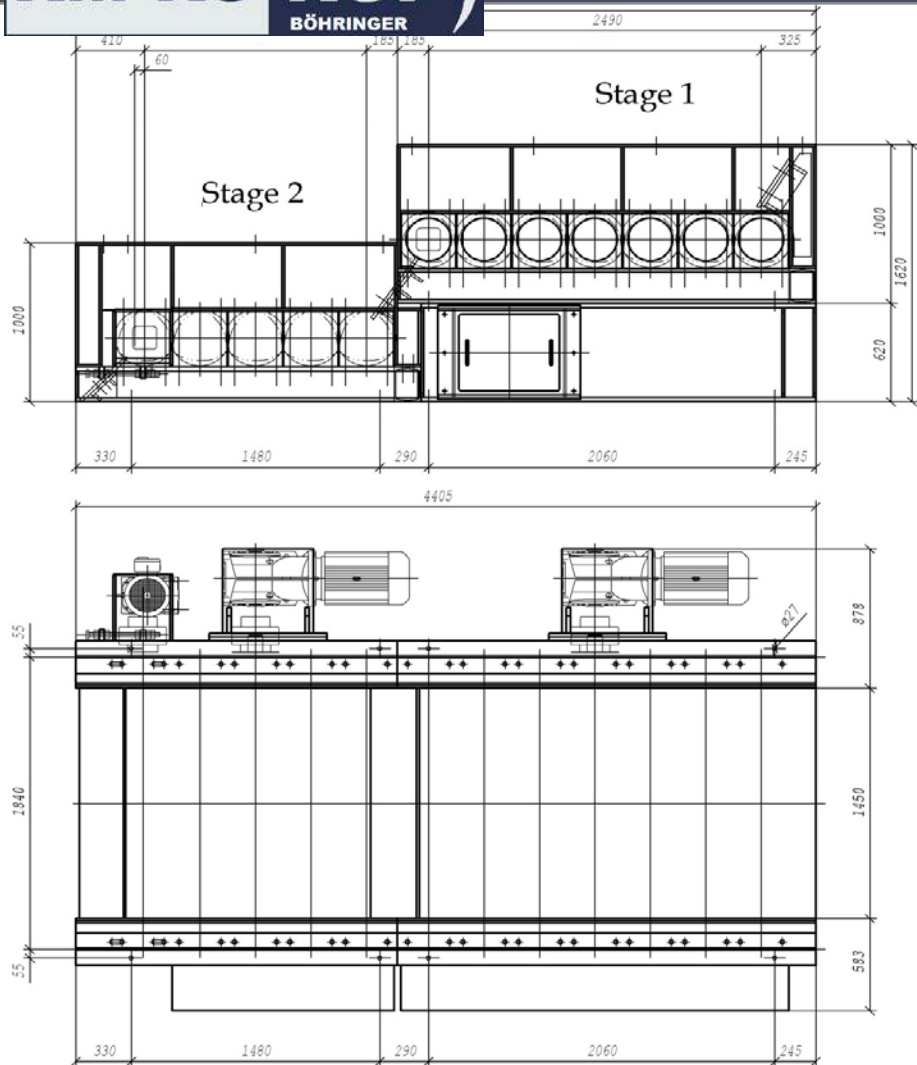

TYPICAL DIMENSION DRAWING
FOR THE:-

RMS 1450MM X 4400MM



Heavy Duty Sprocket and Chain's



ROLLER GRIZZLY FEEDER DRIVE ASSEMBLY



Unique to Böhlinger

**Solid
Through
Shafts**

Heavy Duty bearings and solid housings



Adjustable self cleaning scrapers

*100% SELF CLEANING SCREEN
MAXIMUM RUNNING TIME AND CLEAN MATERIAL
FOR ONWARD PROCESSING*

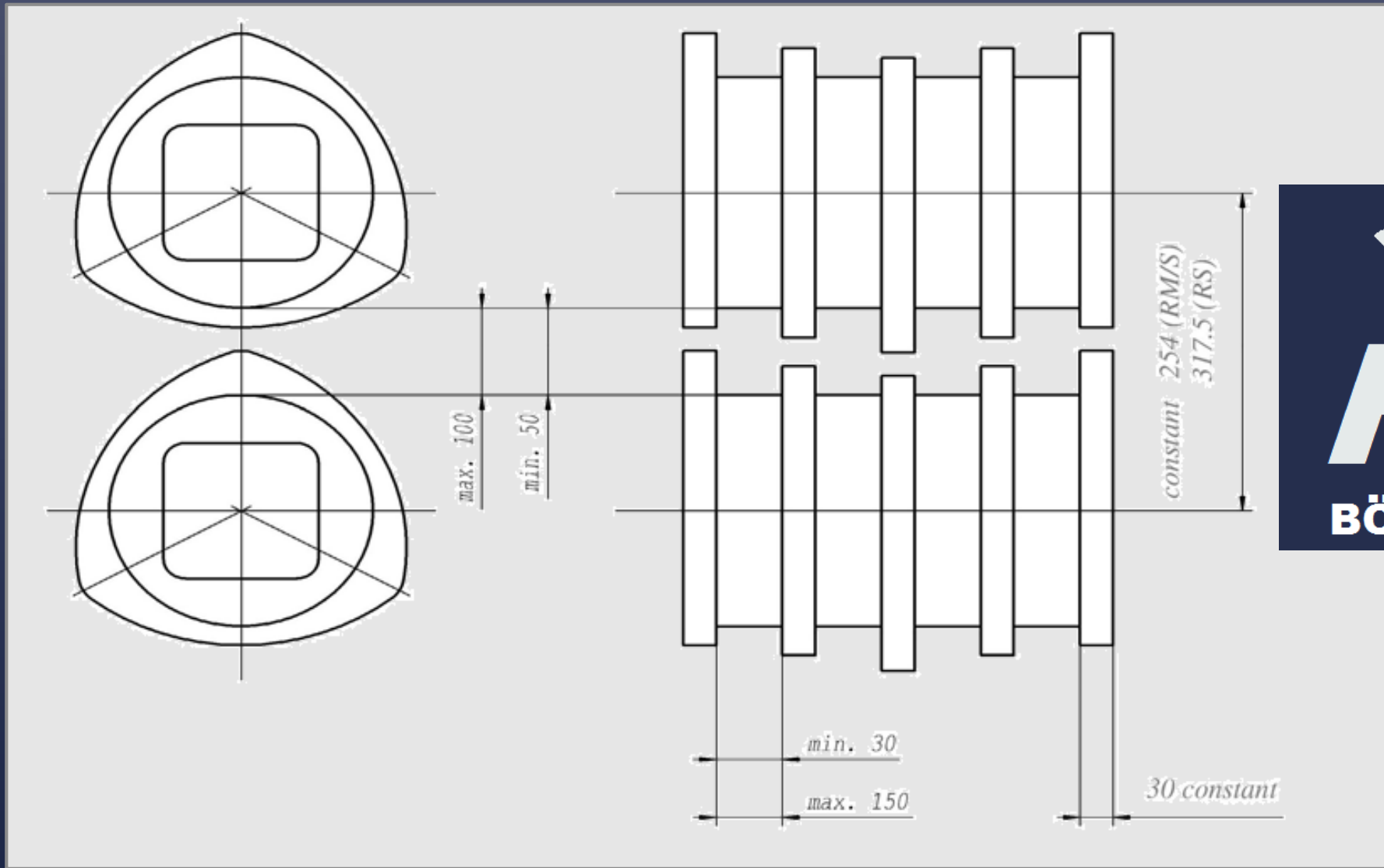



MAXIMUM WIDTH APERTURE 100mm 4"

MINIMUM CLOSED SETTING 50mm 2"

PRE DETERMINED

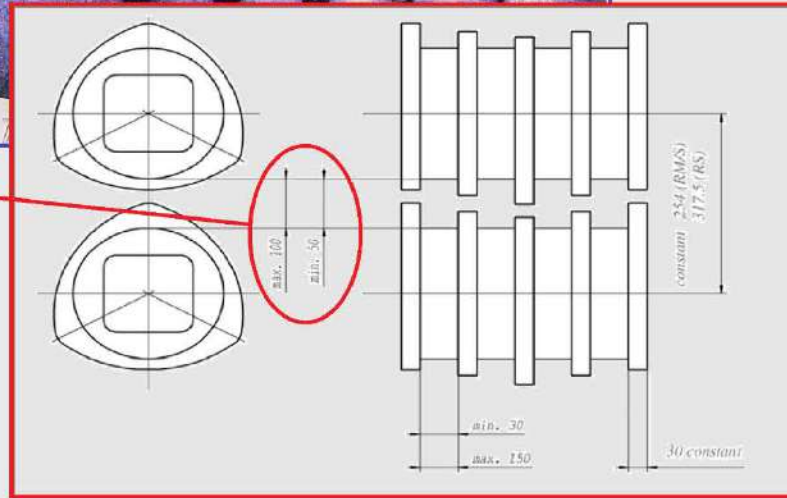

BÖHRINGER	RM 670
DATE 05/2015	
<small>THIS DOCUMENT CONTAINS CONFIDENTIAL AND PROPRIETARY INFORMATION THAT CANNOT BE REPRODUCED OR DIVULGED, IN WHOLE OR IN PART, WITHOUT WRITTEN AUTHORIZATION FROM THE LAWYER, CH. BÖHRINGER INC. 121 MAIN STREET, STE. 140 NORTH HAVEN, NEW YORK 11788. Tel: 631 262 7211 *All Rights Reserved</small>	





ROLLER GRIZZLY FEEDER

Specialty areas of application:
Wet, Sticky contaminated feed material

- Separation Range from 30 to 130 mm
- Capacity approx 100 to 1200 t / h
- Sizes -width: 850-1850 mm
Length: 2000mm to 9000mm



Roller Grizzly Feeder Model -Width x Length	Number of Shafts	Power requirement	Production TPH	Weight KG	Gap Opening MIN. / MAX.
BRR 850 x 2800	7	7.5 kW	100 - 150	7400 - 7900	50/30 to 100/130
BRR 850 x 3000	8	7.5 kW	100 - 150	8500 - 9100	50/30 to 100/130
BRR 1050 x 2600	7	7.5 kW	150 - 250	8800 - 9400	50/30 to 100/130
BRR 1050 x 3000	8	11.0 kW	150 - 250	10100 - 10700	50/30 to 100/130
BRR 1050 x 3300	9	11.0 kW	150 - 250	11400 - 12100	50/30 to 100/130
BRR 1250 x 3000	8	15.0 kW	250 - 350	10400 - 11200	50/30 to 100/130
BRR 1250 x 3300	9	15.0 kW	250 - 350	11600 - 12500	50/30 to 100/130
BRR 1250 x 3600	10	18.5 kW	250 - 350	12900 - 13800	50/30 to 100/130
BRR 1450 x 3600	10	18.5 kW	350 - 500	13200 - 14200	50/30 to 100/130
BRR 1450 x 4000	11	22.0 kW	350 - 500	14500 - 15600	50/30 to 100/130
BRR 1450 x 4300	12	22.0 kW	350 - 500	16800 - 17000	50/30 to 100/130
BRR 1650 x 3600	10	22.0 kW	400 - 650	13500 - 14600	50/30 to 100/130
BRR 1850 x 4000	11	22.0 kW	400 - 650	14900 - 16100	50/30 to 100/130
BRR 1650 x 4300	12	22.0 kW	400 - 650	16200 - 17500	50/30 to 100/130
BRR 1850 x 4600	13	30.0 kW	400 - 650	17600 - 18900	50/30 to 100/130
BRR 1850 x 4000	11	30.0 kW	500 - 750	15800 - 17100	50/30 to 100/130
BRR 1850 x 4300	12	30.0 kW	500 - 750	17200 - 18600	50/30 to 100/130
BRR 1850 x 4600	13	37.0 kW	500 - 750	18600 - 20100	50/30 to 100/130
BRR 1850 x 5000	14	37.0 kW	500 - 750	19900 - 21600	50/30 to 100/130

NOTE ! The material in this specification is for general information and guidance only. No representation is made or given by Böhlinger Inc that its products will be suitable for a user's particular purpose. All related inquiries should always be made of Böhlinger Inc to ensure suitability at all times. Whilst reasonable efforts have been made in preparation of this document to ensure its accuracy Böhlinger Inc assumes no liability resulting from errors or omissions in this document or from the use or interpretation of the information contained herein. Böhlinger Inc reserves the right to change or omit information both in this document and in the product design without reservation and notification to users. "ALL RIGHTS ARE RESERVED"



BOHRINGER
ROLLER GRIZZLY FEEDERS

SERIES "RM" AND "RS"

Heavy duty feeder scalper for contaminated (wet, sticky or dry) raw materials.

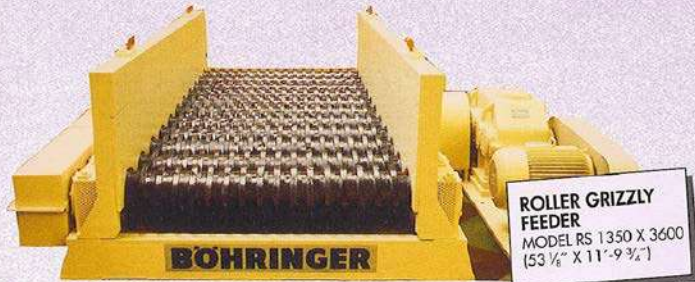

ROLLER GRIZZLY FEEDER
MODEL RS 1350 X 3600
(53 1/8" X 11'-9 3/4")

- Uniform feed rate
- Low headroom
- Low horsepower
- No vibration
- Replaceable push-on discs of wear resistant alloy
- Adjustable Scrapers
- Heavy duty solid square shafts and short roller chains
- Long wear life due to special alloy castings
- High performance, High capacity
- Low per ton operating cost
- Made in America

BOHRINGER, INC.
121 Main Street, STE 140, Northport,
New York 11768. T: 631 262 7211.
www.bohringerinc.com

The Roller Grizzly Feeder consists of:

- heavy duty one-piece welded steel frame
- side walls with bolt-on replaceable wear plates
- solid square shafts with push-on discs of special alloy
- bearing assemblies to support the shafts
- sprockets and chains to turn the shafts
- chain guard with oil bath
- drive assembly with electric motor



The roller grizzly feeder, in its standard configuration, is driven through an electric motor, vee-belt drive and gear reducer. Its output shaft is connected to the feeder input shaft by a flexible coupling. Variable speed drive is available upon request.

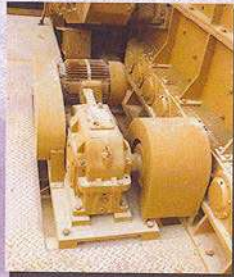

The lower frame has two pedestals for mounting the bolt-on bearing housings. Large spherical roller bearings with labyrinth rings and dust seals support the square shafts.



BOHRINGER, INC.

BOHRINGER, INC.

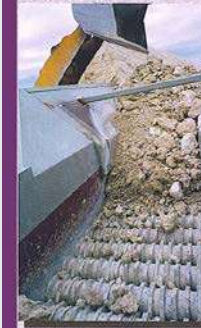

The Roller Grizzly Feeder is generally used as a primary scalper between a vibrating, reciprocating, or apron feeder and a crusher. The unique tumbling action of the discs assures a most efficient separation of fines and conglomerates from the quarried or mined raw material.



Compared to conventional screens or grizzlies, these machines resist clogging in wet or sticky materials and provide self-cleaning of the discs. Material production has been known to increase upwards of 50% due to the scalping efficiency of the roller grizzly feeder which removes the fines and only feeds oversize to the crusher. This furthermore reduces wear cost, since the abrasive fines are removed ahead of the crusher. The heavy duty construction of the roller grizzly feeder offers high availability, top efficiency and low maintenance.



Replaceable cast discs are stacked on the square shafts. Different shapes of discs are available depending on the specific application. The individual shafts are driven through short roller chains (one chain turning two shafts) which are running in an enclosed oil bath. Adjustable scrapers are located under the shafts to prevent plugging and build up between the discs.

ROLLER GRIZZLY FEEDER

Series "RM" - Feed size up to 1000 mm (40") edge length; max. drop height 750 mm (29")

MODEL Width-Length mm	inches	No. of Shafts	Motor (HP)	Approx. Weight (Lbs)*
950 x 4600	37 1/2 x 181 1/8	19	2 x 20	20,500
950 x 5100	37 1/2 x 200 3/4	19	2 x 20	25,600
950 x 5300	37 1/2 x 208 11/16	22	2 x 20	22,900
1030 x 2050	40 1/2 x 80 3/4	7	10	12,500
1030 x 2300	40 1/2 x 90 1/2	8	10	13,900
1030 x 2550	40 1/2 x 100 3/8	9	10	15,400
1070 x 3100	42 1/8 x 122 1/16	11	20	16,500
1070 x 5350	42 1/8 x 210 5/8	20	30	28,600
1190 x 6600	46 7/8 x 259 7/8	25	2 x 20	41,100
1220 x 2650	48 x 104 5/16	9	15	17,300
1270 x 2050	50 x 80 3/4	7	10	12,800
1270 x 2300	50 x 90 1/2	8	10	14,100
1270 x 2550	50 x 100 3/8	9	15	15,800
1270 x 2800	50 x 110 1/4	10	15	17,500
1270 x 3050	50 x 120	11	15	19,100
1270 x 3300	50 x 130	12	20	20,800
1270 x 3550	50 x 139 3/4	13	20	22,400
1270 x 3800	50 x 149 5/8	14	20	24,100
1350 x 2300	53 1/8 x 90 1/2	8	15	15,300
1350 x 2550	53 1/8 x 100 3/8	9	15	17,100
1350 x 2800	53 1/8 x 110 1/4	10	15	18,900
1350 x 3050	53 1/8 x 120	11	15	20,500
1350 x 3300	53 1/8 x 130	12	20	22,300
1350 x 3550	53 1/8 x 139 3/4	13	20	24,100
1350 x 3800	53 1/8 x 149 5/8	14	20	25,800
1350 x 4200	53 1/8 x 165 3/8	15	30	31,000
1350 x 6100	53 1/8 x 240 3/16	23	2 x 25	43,000
1510 x 3050	59 1/2 x 120	11	20	22,200
1510 x 3300	59 1/2 x 130	12	20	24,100
1510 x 3550	59 1/2 x 139 3/4	13	25	25,900
1510 x 3800	59 1/2 x 149 5/8	14	25	27,600
1510 x 4200	59 1/2 x 165 3/8	15	30	29,600
1510 x 9000	59 1/2 x 181 1/8	34	2 x 30	67,600
1800 x 6500	70 7/8 x 255 15/16	24	2 x 30	55,000

ROLLER GRIZZLY FEEDER

Series "RS" - Feed size up to 1500 mm (60") edge length; max. drop height 1000 mm (40")

MODEL Width-Length mm	inches	No. of Shafts	Motor (HP)	Approx. Weight (Lbs)*
1220 x 4700	48 x 185	12	30	37,000
1220 x 5042	48 x 198 1/2	14	2 x 25	41,000
1350 x 3000	53 1/8 x 118 1/8	9	15	25,900
1350 x 3300	53 1/8 x 130	10	20	28,300
1350 x 3600	53 1/8 x 141 3/4	11	25	30,600
1350 x 4000	53 1/8 x 157 1/2	12	30	32,900
1350 x 4330	53 1/8 x 170 1/2	13	2 x 25	38,100
1450 x 3000	57 1/8 x 118 1/8	9	20	26,100
1450 x 3300	57 1/8 x 130	10	25	28,500
1450 x 3400	57 1/8 x 133 7/8	10	25	28,500
1450 x 3600	57 1/8 x 141 3/4	11	25	30,900
1450 x 4000	57 1/8 x 157 1/2	12	30	33,300
1530 x 3300	60 1/4 x 130	10	25	28,600
1530 x 3600	60 1/4 x 141 3/4	11	25	31,100
1530 x 4000	60 1/4 x 157 1/2	12	30	33,700
1530 x 5000	60 1/4 x 196 7/8	15	40	39,700
1570 x 3700	61 7/8 x 145 3/4	11	30	31,900
1610 x 3300	63 3/8 x 130	10	30	31,500
1610 x 3600	63 3/8 x 141 3/4	11	30	34,300
1610 x 4000	63 3/8 x 157 1/2	12	30	37,200
1610 x 4300	63 3/8 x 169 1/4	13	30	39,900
1800 x 3600	70 7/8 x 141 3/4	11	30	34,300
1800 x 4000	70 7/8 x 157 1/2	12	40	37,400
1800 x 4700	70 7/8 x 185	14	40	42,100
2000 x 4000	78 3/4 x 157 1/2	12	40	39,700

*Note: Weight changes with gap opening between discs. Design specifications subject to change without notice. Technical data are approximates and should be used as a guide only. Capacity and power requirements depend on the type and characteristics of the feed material.



BOHRINGER, INC.
121 Main Street, STE 140, Northport,
New York 11768. T: 631 262 7211
www.bohringerinc.com

RGF

BÖHRINGER

The material in this specification is for general information and guidance only. No representation is made or given by Böhringer .Inc. that its products will be suitable for a user's particular purpose. All related inquiries should always be directed to Bohringer. Inc. to ensure suitability at all times. Whilst reasonable efforts have been made in preparation of this document to ensure its accuracy Böhringer . Inc. assumes no liability resulting from errors or omissions in this document or from the use or interpretation of the information contained herein. Böhringer . Inc. reserves the right to change or omit information both in this document and in the product design without reservation and notification to users.



RM-RS **RGF**
BÖHRINGER



RGF
BÖHRINGER

B BÖHRINGER.®

BÖHRINGER IMPACT CRUSHER AND RGF COMBINATION PROCESS WET STICKY OTHERWISE IMPOSSIBLE TO ECONOMICALLY CLEAN MATERIAL.



BEFORE



DURING



AFTER





BÖHRINGER

Böhringer Inc.
121 Main Street STE 140
Northport New York 11768
T: (631) 262 7211
enquiries@bohringerinc.com

www.bohringerinc.com